



# SQUIBB ROAD

FOR SUBLEASE

**27,456 SF Industrial/Flex Space for Sublease**  
±24,956 SF warehouse | ±2,500 SF finished office



27,456 SF | INDUSTRIAL/FLEX SPACE FOR SUBLEASE

# 6800 SQUIBB ROAD

MISSION, KS | \$8.50 PSF NNN

Sublease through July 31st, 2037 (open to shorter terms)



## PROPERTY OVERVIEW

6800 Squibb Road is a 27,456-square-foot industrial/flex building on 1.89 acres in Mission, Kansas. With dock access, ample parking, and quick I-35 access, it offers functional, accessible space ideal for light industrial use.

## PROPERTY HIGHLIGHTS

- 18' building height and 14' clear ceilings suitable for light manufacturing, warehousing, or distribution
- Three exterior dock-high doors and two levelers provide excellent loading capabilities
- 800a / 480v
- Located at the intersect of Metcalf Avenue & Shawnee Mission Parkway, minutes from I-35
- Ample on-site parking
- Zoning: MP



## FOR MORE INFORMATION, CONTACT

### MILES MCCUNE

President & Founder

Direct: 816.831.1402

[miles.mccune@range-rp.com](mailto:miles.mccune@range-rp.com)

### ELLEN FISHER

Vice President

Direct: 816.589.0012

[ellen.fisher@range-rp.com](mailto:ellen.fisher@range-rp.com)



**RANGE**  
REALTY PARTNERS

27,456 SF | INDUSTRIAL/FLEX SPACE FOR SUBLEASE

# 6800 SQUIBB ROAD

MISSION, KS | \$8.50 PSF NNN



**RANGE**  
REALTY PARTNERS

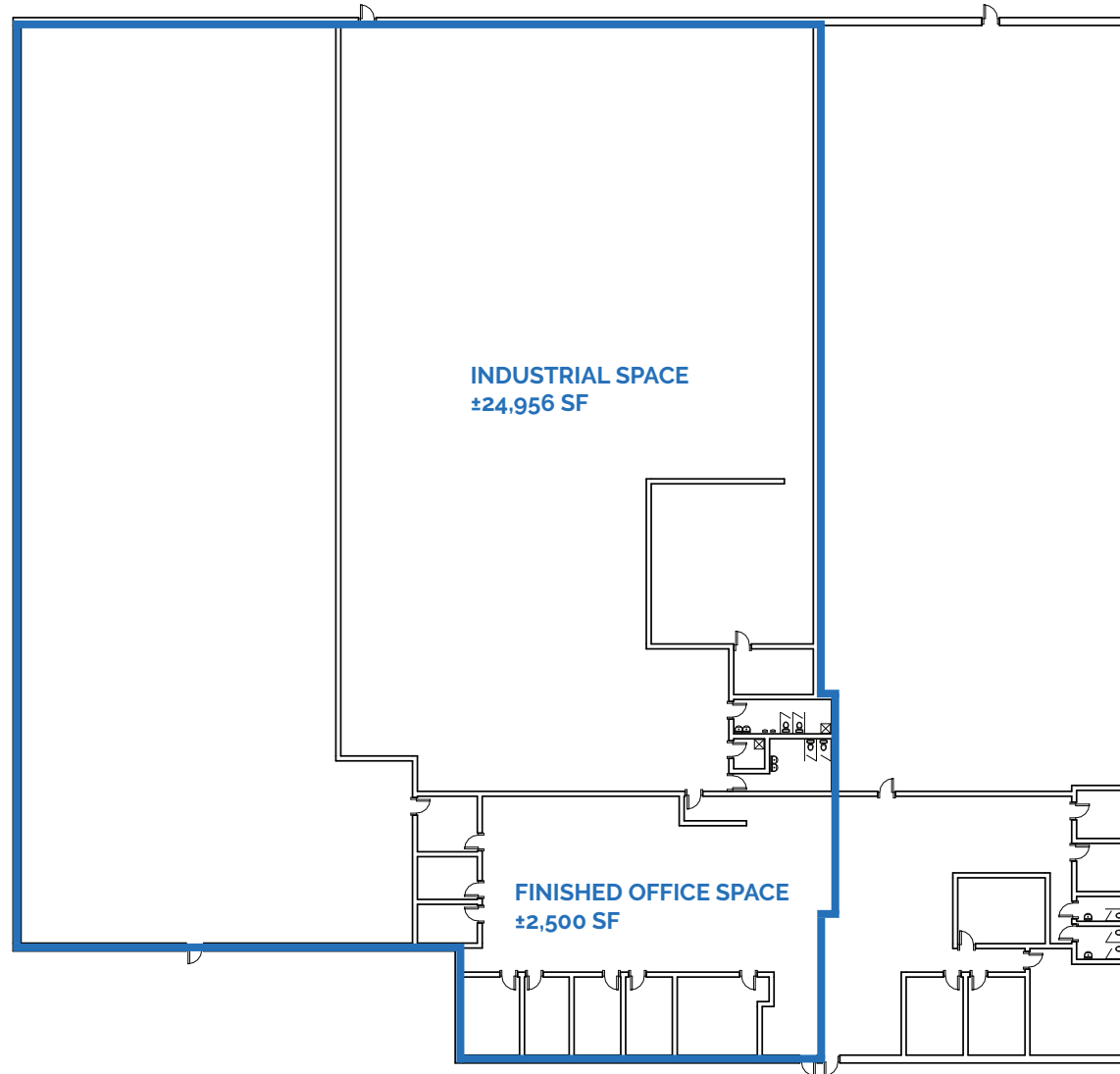



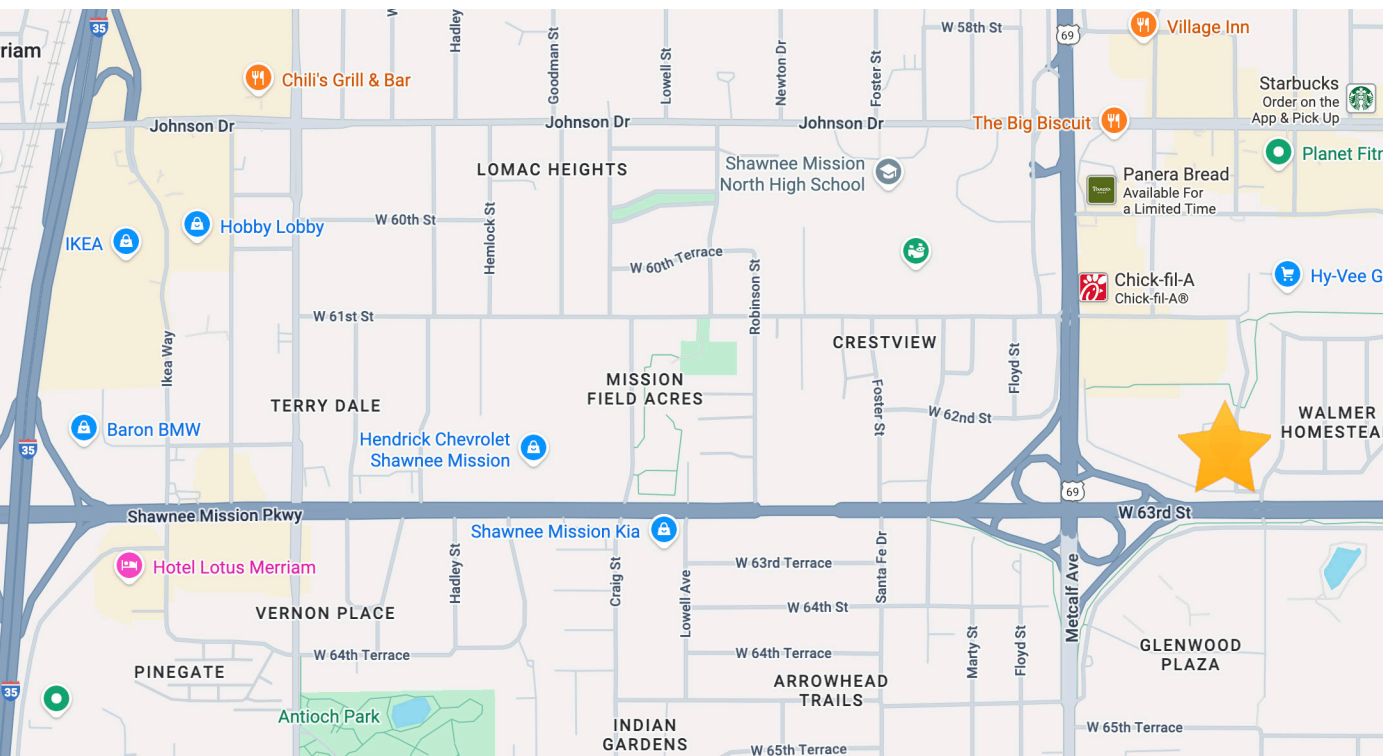

27,456 SF | INDUSTRIAL/FLEX SPACE FOR SUBLEASE

## 6800 SQUIBB ROAD

MISSION, KS | \$8.50 PSF NNN

### FOR MORE INFORMATION, CONTACT

#### MILES MCCUNE

President & Founder

Direct: 816.831.1402

[miles.mccune@range-rp.com](mailto:miles.mccune@range-rp.com)

#### ELLEN FISHER

Vice President

Direct: 816.589.0012

[ellen.fisher@range-rp.com](mailto:ellen.fisher@range-rp.com)



**RANGE**  
REALTY PARTNERS